

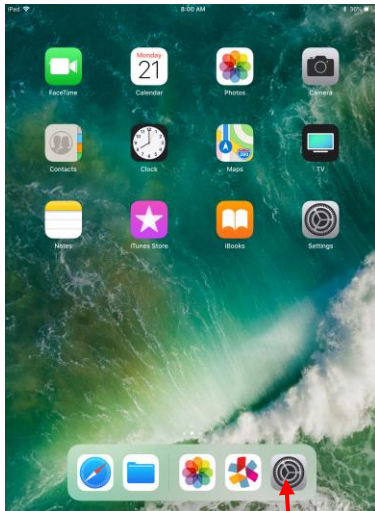

Connecting your iPad to Wi-Fi at home

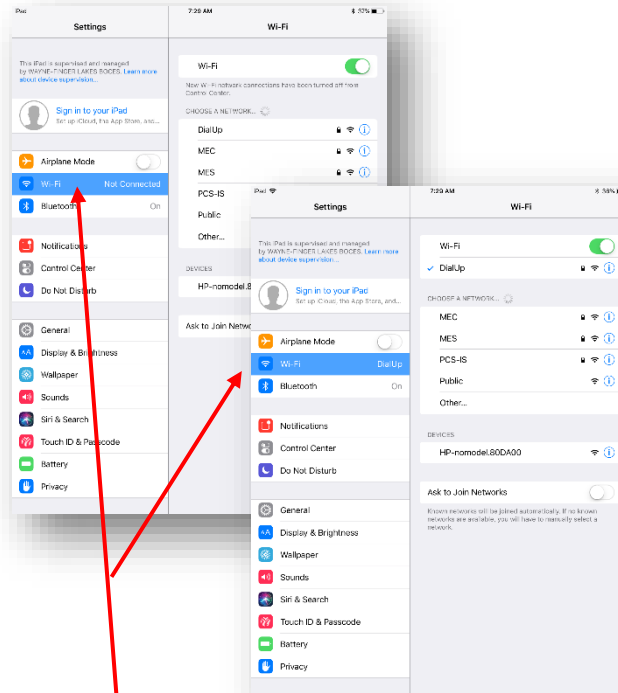

1. Open your settings



2. Select Wi-Fi and add your home Wi-Fi. You will need to know the name of your network and the password (if you have one.)

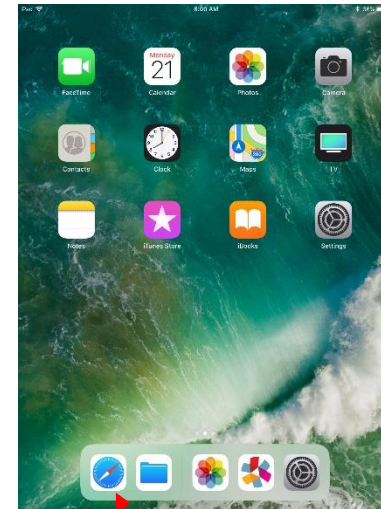

3. Return to your home screen and open Safari

Go to:

<http://lakenet-team.edutech.org/mobilelogin2.html>

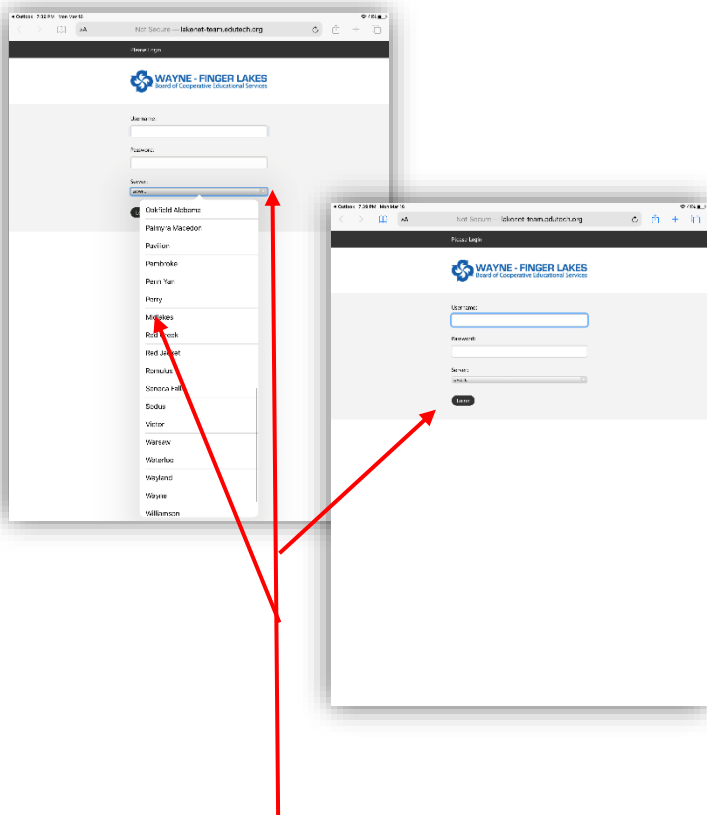

4. Enter your school login information

Username: firstname.lastname

Password: k-5 this is your 5-digit code; 6-12 you created your own password

Server: select *Midlakes* from the dropdown (please note: Midlakes is in the P section for Phelps-Clifton Springs)

Login: click *login*

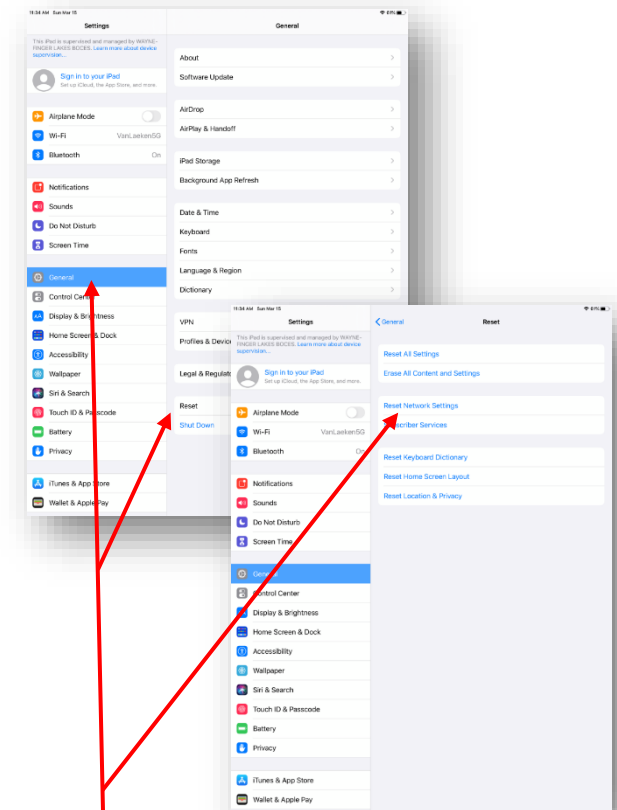
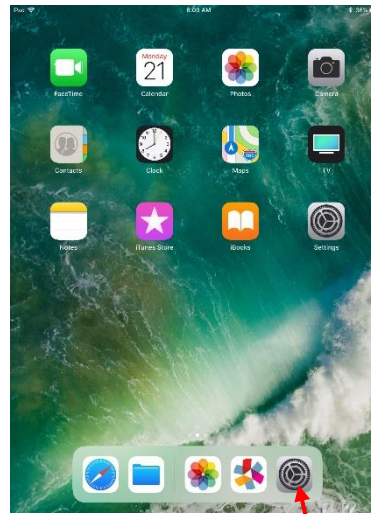

iPad still not working like it does at school? You will need to reset your network settings.

- Return to home screen and open settings
- Scroll down and select **GENERAL**
- Scroll down and select **RESET**
- Select **RESET NETWORK SETTINGS**
- Repeat steps 1 - 4